

STAINLESS HOLLOW PIN CHAIN

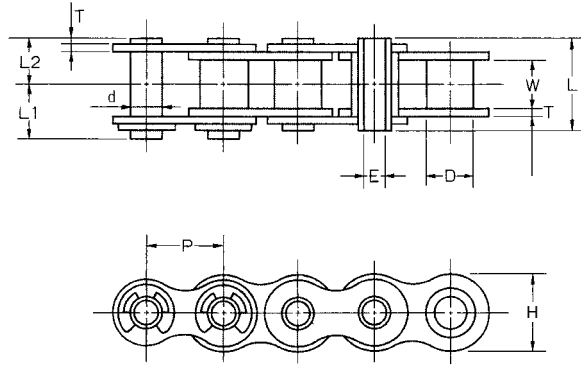

CHAIN IS ROLLERLESS

UNIT Upper:inch
Beneath:mm

OCM Chain No.	Pitch	Roller Diam.	Width between L.P.	Pin Diam.	Trans Pitch	Pin			Link Plate		Allowable Load	Approx Weight
	P	D	W	d	E (MIN)	L	L1	L2	H	T	Lb/kgf	Lb/ft kg/m
40HP SUS	0.500 12.7	0.312 7.92	0.313 7.95	0.222 5.65	0.157 4	0.63 16	0.362 9.2	0.315 8	0.472 12	0.059 1.5	99 45	0.34 0.51
50HP SUS	0.625 15.875	0.4 10.16	0.376 9.55	0.284 7.21	0.202 5.12	0.799 20.3	0.451 11.45	0.4 10.15	0.591 15	0.079 2	165 75	0.56 0.84
60HP SUS	0.750 19.05	0.469 11.91	0.5 12.7	0.327 8.3	0.236 6	1 25.4	0.559 14.2	0.5 12.7	0.709 18	0.094 2.4	231 105	0.83 1.23
80HP SUS	1.000 25.4	0.625 15.88	0.626 15.9	0.433 11	0.315 8	1.287 32.7	0.703 17.85	0.644 16.35	0.949 24.1	0.126 3.2	397 180	1.48 2.2

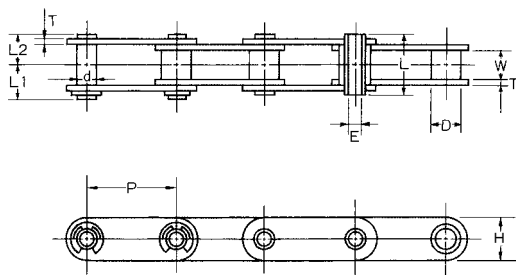

TYPE ROLLERLESS

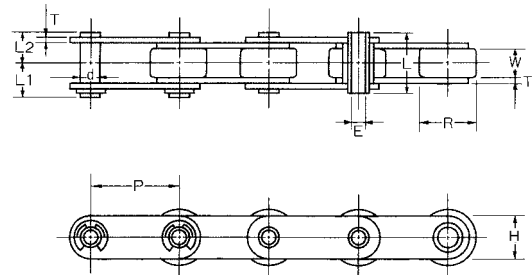

TYPE LARGE ROLLER

UNIT Upper:inch
Beneath:mm

OCM Chain No.	Pitch	Roller Diam.		Width between L.P.	Pin Diam.		Pin			Link Plate		Allowable Load	Approx Weight	
	P	D	R	W	d	E(MIN)	L	L1	L2	H	T	Lb/kgf	Lb/ft kg/m	
C2040HP-C2042HP SUS	1.000 25.4	0.312 7.92	0.625 15.88	0.313 7.95	0.222 5.65	0.157 4	0.63 16	0.362 9.2	0.315 8	0.472 12	0.059 1.5	99 45	0.3 0.45	0.53 0.79
C2050HP-C2052HP SUS	1.250 31.75	0.4 10.16	0.75 19.05	0.376 9.55	0.284 7.21	0.202 5.12	0.799 20.3	0.451 11.45	0.4 10.15	0.591 15	0.079 2	165 75	0.5 0.74	0.8 1.19
C2060HP-C2062HP SUS	1.500 38.1	0.469 11.91	0.875 22.23	0.5 12.7	0.327 8.3	0.236 6	1 25.4	0.559 14.2	0.5 12.7	0.677 17.2	0.094 2.4	231 105	0.69 1.02	1.15 1.71
C2080HP-C2082HP SUS	2.000 50.8	0.625 15.88	1.125 28.58	0.626 15.9	0.433 11	0.315 8	1.287 32.7	0.703 17.85	0.644 16.35	0.945 24	0.126 3.2	397 180	1.28 1.91	1.98 2.94