

# DOUBLE PITCH PLALINK CHAIN

Plalink chain is made up of each outside link with plastic plate and carbon steel plate. Smoothness of plastic prevents products conveyed from being damaged. Carbon steel plates keep a steel strength.

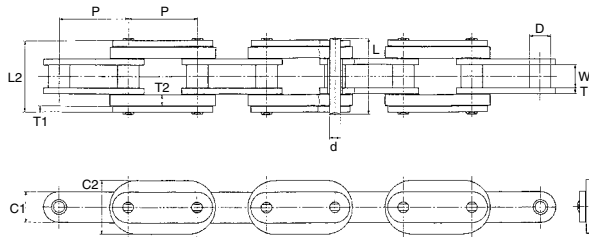

UNIT Upper:inch  
Beneath:mm

OCM Chain No.	Pitch	Roller Diam.	Width between L.P.	Link Plate				Pin Diam.	Pin		Max Allowable Tension	Max Load	Approx Weight
	P	D	W	C1	C2	T1	T2	d	L	L2	Lb/kgf	per ft/Lb per m/kgf	Lb/ft kg/m
PLKC2060H	1.5	0.469	0.5	0.677	1.181	0.126	0.236	0.234	1.634	1.543	767	16.79	1.076
	38.1	11.91	12.7	17.2	30	3.2	6	5.95	41.5	39.2	348	25	1.6

Chain with plastic roller (Polyacetal)

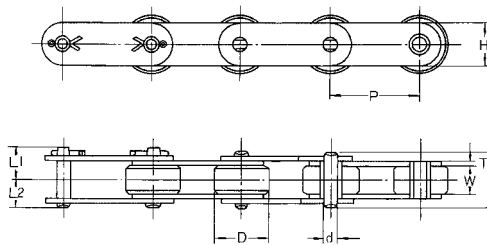

UNIT Upper:inch  
Beneath:mm

OCM Chain No.	Pitch	Roller Diam.	Width between L.P.	Link Plate		Pin Diam.	Pin			Average Tensile Strength	Allowable Load	Allowable Load of Roller	Weight
	P	D	W	H	T	d	L	L1	L2	Lb/kgf	Lb/kgf	Lb/kgf	Lb/ft kg/m
C2042	1.000	0.625	0.313	0.472	0.059	0.156	0.634	0.319	0.382	4.300	99	44	0.334
	25.40	15.88	7.95	12.0	1.5	3.96	16.1	8.1	9.7	1.950	45	20	0.50
C2052	1.250	0.750	0.376	0.591	0.079	0.200	0.799	0.409	0.476	7.056	165	66	0.547
	31.75	19.05	9.55	15.0	2.0	5.08	20.3	10.4	12.1	3.200	75	30	0.82
C2062H	1.500	0.875	0.500	0.677	0.126	0.234	1.130	0.563	0.650	9.812	232	110	0.987
	38.10	22.23	12.7	17.2	3.2	5.95	28.7	14.3	16.5	4.450	105	50	1.48
C2082H	2.000	1.125	0.626	0.945	0.157	0.313	1.413	0.709	0.839	16.538	397	198	1.734
	50.80	28.58	15.9	24.0	4.0	7.94	35.9	18.0	21.3	7.500	180	90	2.60

Fish conveying chain with sharp pointed pin

