

OCM ANSI ROLLER CHAIN

Chain No. **41** Pitch • 0.500inch / 12.70mm

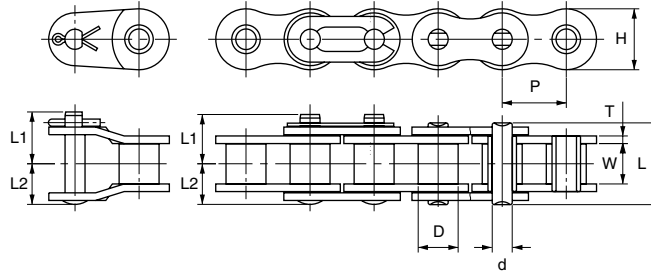

UNIT Upper:inch
Beneath:mm

| OCM Chain No. | ANSI No. | Pitch | Roller Diam. | Width between L.P. | Link Plate | | Pin Diam. | Pin | | | Average Tensile Strength | Max. Working Load | Approx Weight |
|---------------|----------|----------------|---------------|--------------------|--------------|---------------|---------------|---------------|--------------|--------------|--------------------------|-------------------|---------------|
| | | P | D | W | H | T | d | L | L1 | L2 | Lb/kg | Lb/kg | Lb/ft kg/m |
| OCM41 | 41 | 0.500 12.70 | 0.306 7.77 | 0.252 6.4 | 0.382 9.7 | 0.049 1.25 | 0.141 3.58 | 0.524 13.3 | 0.315 8.0 | 0.268 6.8 | 2,392 1,090 | 463 210 | 0.273 0.41 |

1. No multiple strand is available.
2. Available only in rivetted construction.
Note: Dimensions subject to change. Certified dimensions furnished upon request.

HORSEPOWER RATINGS SINGLE STRAND ROLLER CHAIN

| No. of Teeth Small Spkt. | REVOLUTIONS PER MINUTE-SMALL SPROCKET | | | | | | | | | | | | | | | | | | | | | | | | |
|--------------------------|---------------------------------------|------|------|------|------|------|------|------|------|------|------|------|------|------|------|------|------|------|------|------|------|------|------|------|------|
| | 10 | 25 | 50 | 100 | 200 | 300 | 400 | 500 | 700 | 900 | 1000 | 1200 | 1400 | 1600 | 1800 | 2100 | 2400 | 2700 | 3000 | 3500 | 4000 | 5000 | 6000 | 7000 | 8000 |
| 11 | 0.03 | 0.07 | 0.13 | 0.24 | 0.44 | 0.64 | 0.82 | 1.01 | 1.37 | 1.71 | 1.88 | 1.71 | 1.36 | 1.11 | 0.93 | 0.74 | 0.61 | 0.51 | 0.43 | 0.34 | 0.28 | 0.20 | 0.15 | 0.12 | 0.10 |
| 12 | 0.03 | 0.07 | 0.14 | 0.26 | 0.49 | 0.70 | 0.91 | 1.11 | 1.50 | 1.88 | 2.07 | 1.95 | 1.55 | 1.27 | 1.06 | 0.84 | 0.69 | 0.58 | 0.49 | 0.39 | 0.32 | 0.23 | 0.17 | 0.14 | 0.11 |
| 13 | 0.04 | 0.08 | 0.15 | 0.28 | 0.53 | 0.76 | 0.99 | 1.21 | 1.63 | 2.05 | 2.25 | 2.20 | 1.75 | 1.43 | 1.20 | 0.95 | 0.78 | 0.65 | 0.56 | 0.44 | 0.36 | 0.26 | 0.20 | 0.16 | 0.13 |
| 14 | 0.04 | 0.09 | 0.16 | 0.31 | 0.57 | 0.83 | 1.07 | 1.31 | 1.77 | 2.22 | 2.44 | 2.46 | 1.95 | 1.60 | 1.34 | 1.06 | 0.87 | 0.73 | 0.62 | 0.49 | 0.40 | 0.29 | 0.22 | 0.17 | 0.14 |
| 15 | 0.04 | 0.09 | 0.18 | 0.33 | 0.62 | 0.89 | 1.15 | 1.41 | 1.91 | 2.39 | 2.63 | 2.73 | 2.17 | 1.77 | 1.49 | 1.18 | 0.96 | 0.81 | 0.69 | 0.55 | 0.45 | 0.32 | 0.24 | 0.19 | 0.16 |
| 16 | 0.04 | 0.10 | 0.19 | 0.36 | 0.66 | 0.95 | 1.24 | 1.51 | 2.05 | 2.57 | 2.82 | 3.01 | 2.39 | 1.95 | 1.64 | 1.30 | 1.06 | 0.89 | 0.76 | 0.60 | 0.49 | 0.35 | 0.27 | 0.21 | 0.17 |
| 17 | 0.05 | 0.11 | 0.20 | 0.38 | 0.71 | 1.02 | 1.32 | 1.61 | 2.18 | 2.74 | 3.01 | 3.29 | 2.61 | 2.14 | 1.79 | 1.42 | 1.16 | 0.98 | 0.83 | 0.66 | 0.54 | 0.39 | 0.29 | 0.23 | 0.19 |
| 18 | 0.05 | 0.12 | 0.22 | 0.40 | 0.75 | 1.08 | 1.40 | 1.72 | 2.32 | 2.91 | 3.20 | 3.59 | 2.85 | 2.33 | 1.95 | 1.55 | 1.27 | 1.06 | 0.91 | 0.72 | 0.59 | 0.42 | 0.32 | 0.25 | 0 |
| 19 | 0.05 | 0.12 | 0.23 | 0.43 | 0.80 | 1.15 | 1.49 | 1.82 | 2.46 | 3.09 | 3.40 | 3.89 | 3.09 | 2.53 | 2.12 | 1.68 | 1.38 | 1.15 | 0.98 | 0.78 | 0.64 | 0.46 | 0.35 | 0.28 | 0 |
| 20 | 0.06 | 0.13 | 0.24 | 0.45 | 0.84 | 1.21 | 1.57 | 1.92 | 2.60 | 3.26 | 3.59 | 4.20 | 3.33 | 2.73 | 2.29 | 1.81 | 1.49 | 1.24 | 1.06 | 0.84 | 0.69 | 0.49 | 0.38 | 0.30 | 0 |
| 21 | 0.06 | 0.14 | 0.26 | 0.48 | 0.89 | 1.28 | 1.66 | 2.03 | 2.74 | 3.44 | 3.78 | 4.46 | 3.59 | 2.94 | 2.46 | 1.95 | 1.60 | 1.34 | 1.14 | 0.91 | 0.74 | 0.53 | 0.40 | 0.32 | 0 |
| 22 | 0.06 | 0.14 | 0.27 | 0.50 | 0.93 | 1.35 | 1.74 | 2.13 | 2.89 | 3.62 | 3.98 | 4.69 | 3.85 | 3.15 | 2.64 | 2.09 | 1.71 | 1.44 | 1.23 | 0.97 | 0.80 | 0.57 | 0.43 | 0.34 | 0 |
| 23 | 0.06 | 0.15 | 0.28 | 0.53 | 0.98 | 1.41 | 1.83 | 2.24 | 3.03 | 3.80 | 4.17 | 4.92 | 4.11 | 3.37 | 2.82 | 2.24 | 1.83 | 1.54 | 1.31 | 1.04 | 0.85 | 0.61 | 0.46 | 0.37 | 0 |
| 24 | 0.07 | 0.16 | 0.29 | 0.55 | 1.03 | 1.48 | 1.92 | 2.34 | 3.17 | 3.97 | 4.37 | 5.15 | 4.38 | 3.59 | 3.01 | 2.39 | 1.95 | 1.64 | 1.40 | 1.11 | 0.91 | 0.65 | 0.49 | 0.39 | 0 |
| 25 | 0.07 | 0.17 | 0.31 | 0.57 | 1.07 | 1.55 | 2.00 | 2.45 | 3.31 | 4.15 | 4.57 | 5.38 | 4.66 | 3.81 | 3.20 | 2.54 | 2.08 | 1.74 | 1.49 | 1.18 | 0.96 | 0.69 | 0.53 | 0 | 0 |
| 26 | 0.07 | 0.17 | 0.32 | 0.60 | 1.12 | 1.61 | 2.09 | 2.55 | 3.46 | 4.33 | 4.76 | 5.61 | 4.94 | 4.05 | 3.39 | 2.69 | 2.20 | 1.85 | 1.58 | 1.25 | 1.02 | 0.73 | 0.56 | 0 | 0 |
| 28 | 0.08 | 0.19 | 0.35 | 0.65 | 1.21 | 1.75 | 2.26 | 2.77 | 3.74 | 4.69 | 5.16 | 6.08 | 5.52 | 4.52 | 3.79 | 3.01 | 2.46 | 2.06 | 1.76 | 1.40 | 1.14 | 0.82 | 0.62 | 0 | 0 |
| 30 | 0.08 | 0.20 | 0.38 | 0.70 | 1.31 | 1.88 | 2.44 | 2.98 | 4.03 | 5.06 | 5.56 | 6.55 | 6.13 | 5.01 | 4.20 | 3.33 | 2.73 | 2.29 | 1.95 | 1.55 | 1.27 | 0.91 | 0.69 | 0 | 0 |
| 32 | 0.09 | 0.22 | 0.40 | 0.75 | 1.40 | 2.02 | 2.61 | 3.20 | 4.33 | 5.42 | 5.96 | 7.03 | 6.75 | 5.52 | 4.63 | 3.67 | 3.01 | 2.52 | 2.15 | 1.71 | 1.40 | 1.00 | 0 | 0 | 0 |
| 35 | 0.10 | 0.24 | 0.44 | 0.83 | 1.54 | 2.22 | 2.88 | 3.52 | 4.76 | 5.97 | 6.57 | 7.74 | 7.72 | 6.32 | 5.29 | 4.20 | 3.44 | 2.88 | 2.46 | 1.95 | 1.60 | 1.14 | 0 | 0 | 0 |
| 40 | 0.12 | 0.27 | 0.51 | 0.96 | 1.78 | 2.57 | 3.33 | 4.07 | 5.50 | 6.90 | 7.59 | 8.94 | 9.43 | 7.72 | 6.47 | 5.13 | 4.20 | 3.52 | 3.01 | 2.39 | 1.95 | 1.40 | 0 | 0 | 0 |
| Lubrication | I | | | | II | | | | | | | | III | | | | | | | | | | | | |

See page 14. for lubrication type.
For horsepower ratings of multiple strand, multiply the horsepower above by multiple strand factor on page 11.
Note: Dimensions subject to change. Certified dimensions furnished upon request.