

滚子链 ROLLER CHAIN

滚子链的制造

滚子链是由内链节和外链节构成。
内链节由配置两个自由回转滚子的两个套筒压合在内链板组合而成。外链节由两个销轴压合两个外链板组合而成。

销轴有两种型式，铆头环接式和开口销式。

CONSTRUCTION OF ROLLER CHAIN

Roller chain is made up of roller links and pin links. Roller link consists of two bushings press-fitted into roller link plates with two free rotating rollers over the bushings. Pin link consists of two pin link plates into which two pins are press-fitted.

There are two types of pins. Rivet and cotter types.

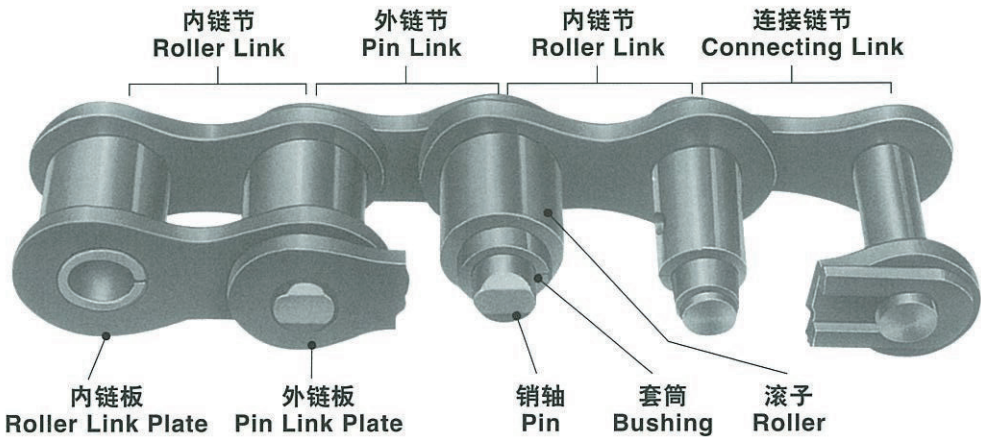

滚子链的连接 ROLLER CHAIN CONNECTION

连接链节 CONNECTING LINKS

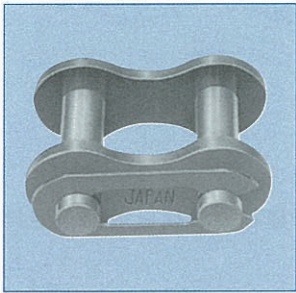

1) 卡簧片式

对于所有单排和多排ANSI标准80及80以下链条、英国标准16B及16B以下链条，卡簧片式为标准型。

Spring clip type

This is standard for all single and multiple strand ANSI standard chain, 80 and below and British standard chain, 16B and below.

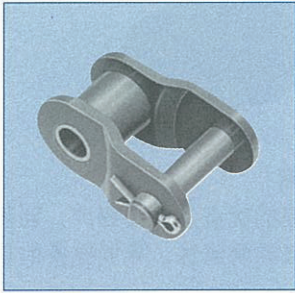

3) 过渡链节

过渡链节是外链节和内链节的组合。该链节用于链条长度中节距数为偶数的链条。建议尽可能不要使用过渡链节。

Offset Link

An offset link is a combination of a roller link and a pin link. This link is used where the chain length is an odd number of pitches. It is recommended not to use an offset link whenever possible.

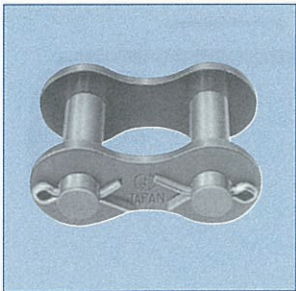

2) 开口销式

对于所有单排和多排ANSI标准100及100以上链条、英国标准20B及20B以上链条，开口销式为标准型。

Cotter type

This is standard for all single and multiple strand ANSI 100 and above, and British standard 20B and above.

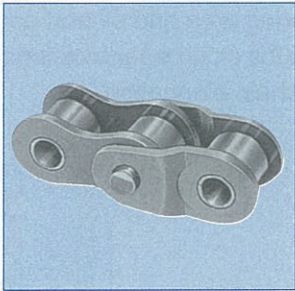

4) 双节距过渡链节

该组件由一个过渡链节和一个内链节构成。销轴压入链板，该组件比单节距过渡链节更适于重击载荷和高速传动作业。

Two Pitch Offset Link

The unit consists of one offset and one roller link. Pins are press-fitted into the link plates and the unit is more suitable for heavy impact load and high speed driving than one pitch offset link.